

**GENERAL NOTES:**

- Applicant: City of Cape May, 643 Washington Street, Cape May, NJ 08204. Property Address: Lafayette Street Park, 711 Lafayette Street, Cape May, NJ 08204.
- The project site is known as Block 1061, Lots 42, 51, 53, 54.01 & 54.02, as shown on the City of Cape May Tax Map, Sheets #13 & 19.
- The purpose of this plan is to accompany applications for an NJDEP Freshwater Wetlands General Permit #17 - Trails and Boardwalks (N.J.A.C. 7:7A-7.17) and an NJDEP Coastal General Permit #13 - Construction of Recreational Facilities at Public Parks.
- Outbound and Topographic information taken from plan entitled "Partial Topographic Survey" situate in Block 1061, Part of Lots 42, 43, 44, 47, 48, 49, 50, 51, 52, 53 & 54, City of Cape May, Cape May County, NJ prepared by Cape Land Surveying, George Swensen, NJPLS #43415, dated 3/23/2023.
- Elevations are in feet and refer to NAVD 1988.

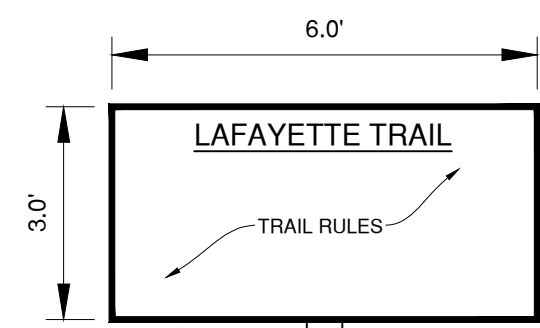

INFORMATIONAL SIGN DETAIL N.T.S.

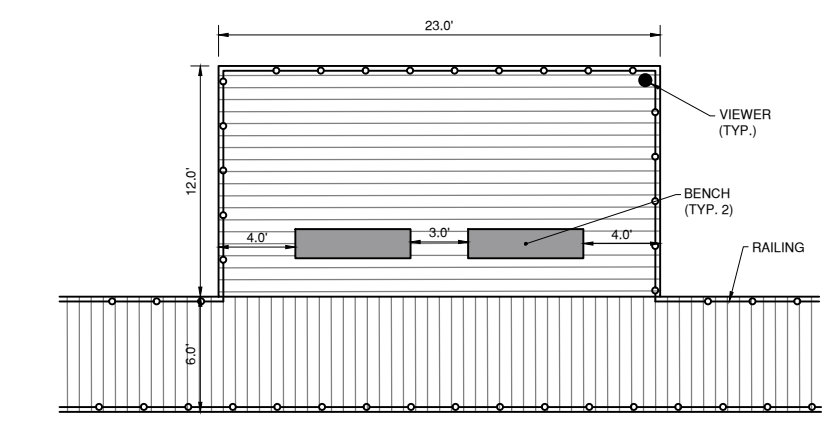

VIEWING PLATFORM DETAIL 1"=10'

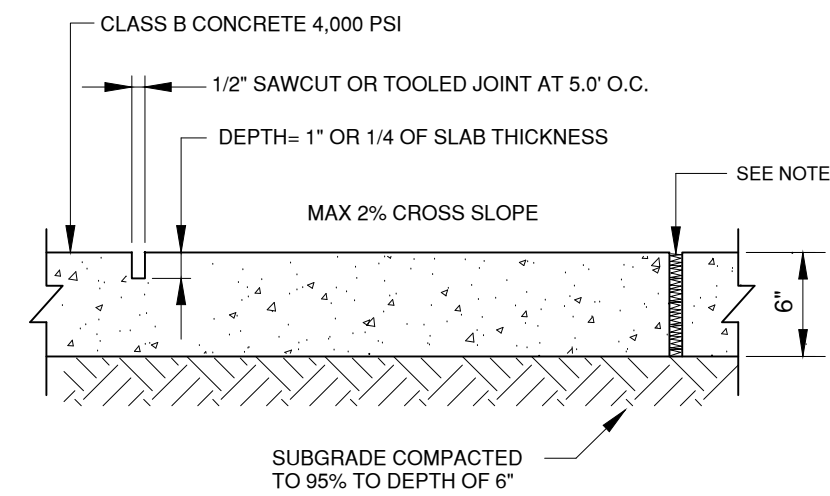

CONCRETE WALKWAY DETAIL N.T.S.

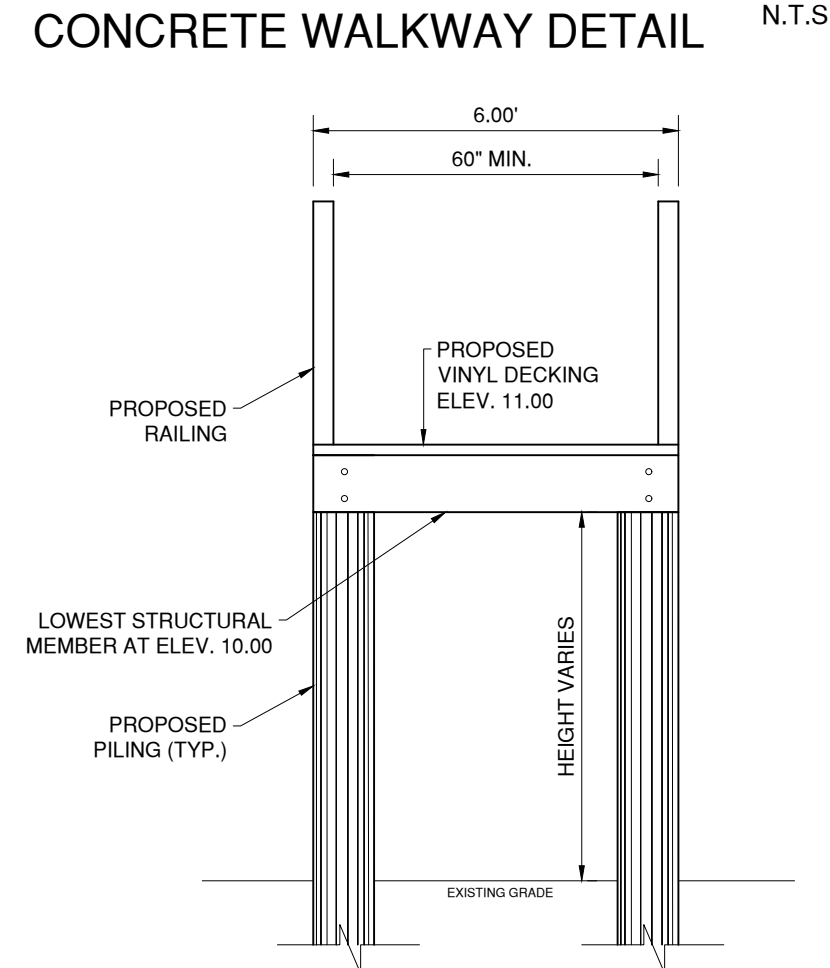

BOARDWALK DETAIL N.T.S.

# NJDEP FWW GP #17 COASTAL GP #13

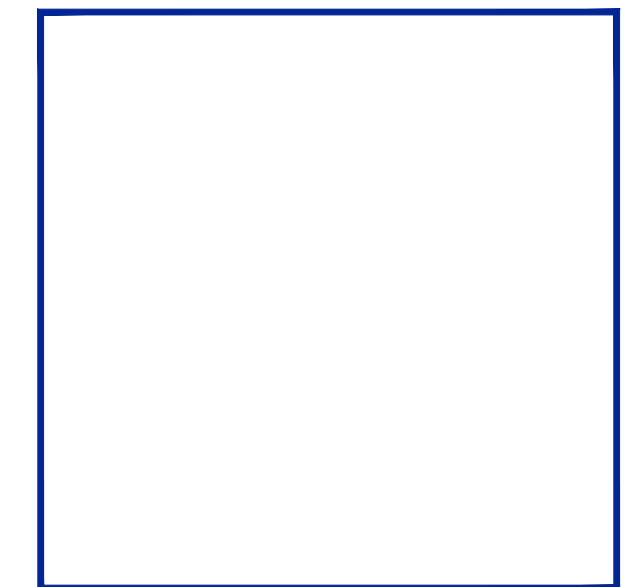
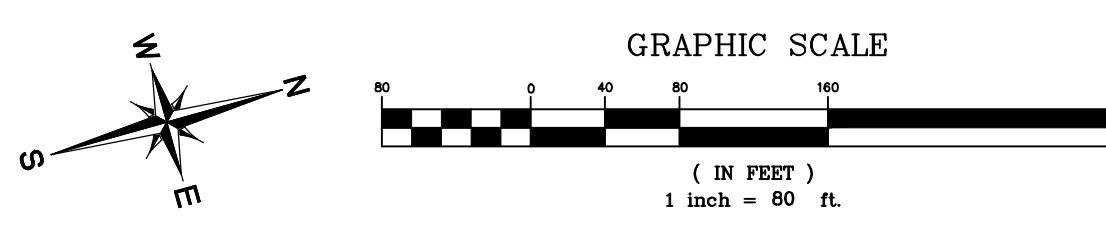
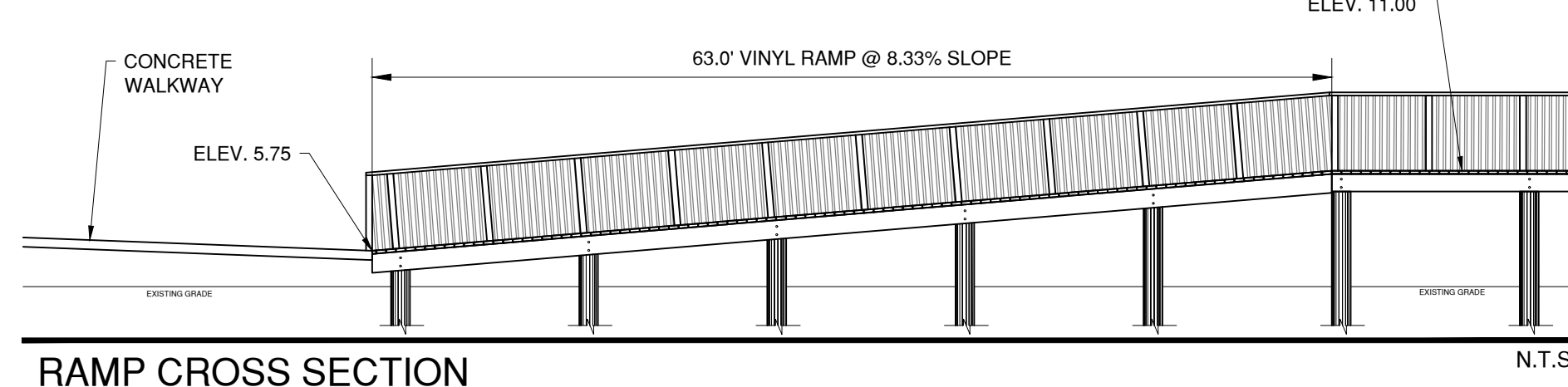
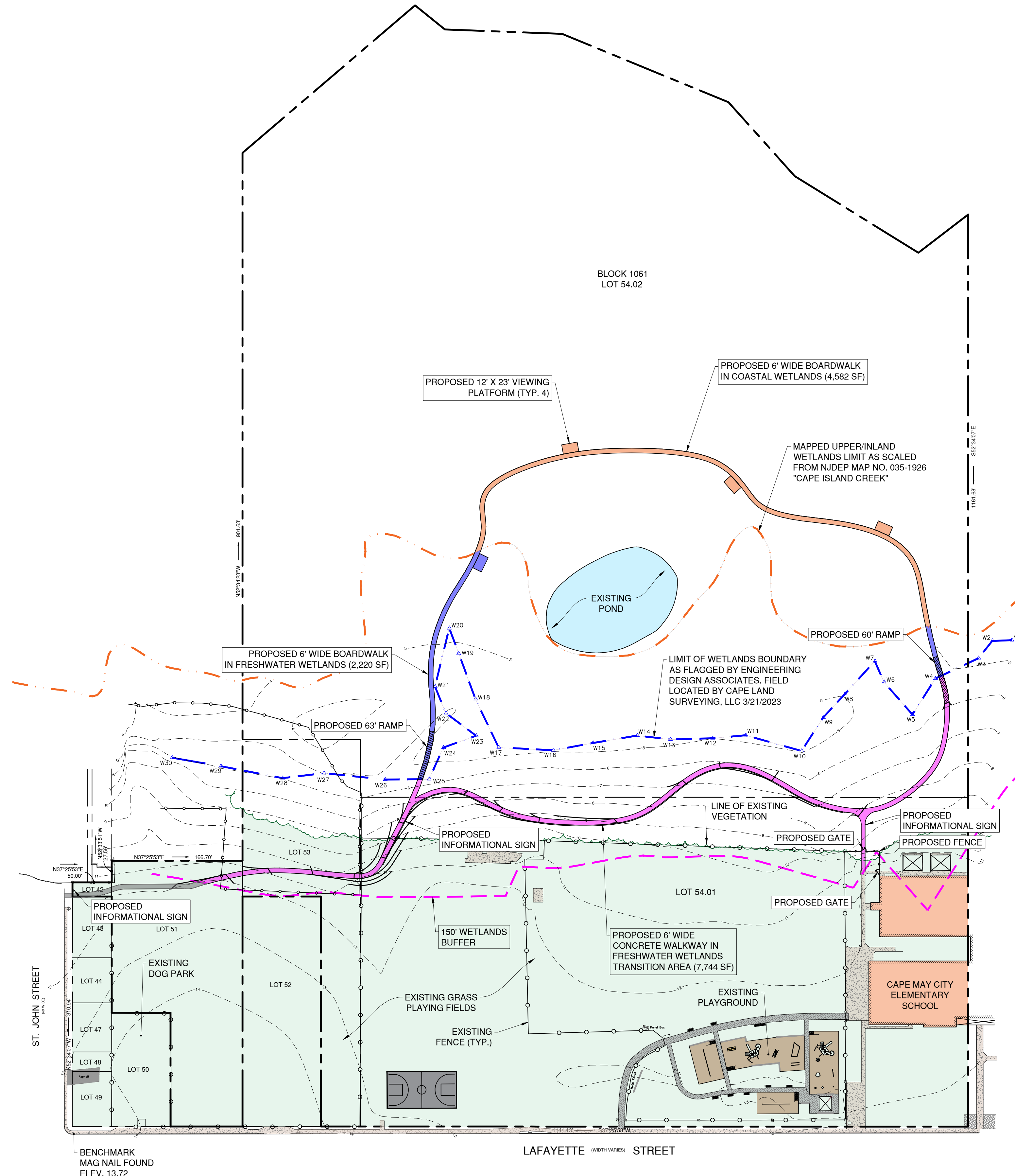

**EDA** Engineering Design Associates, P.A.  
 Environmental Planners, Landscape Architects  
 CAMBRIDGE PROFESSIONAL OFFICES  
 5 Cambridge Drive, Ocean View, New Jersey, 08230  
 (609) 390-0332 • Fax (609) 390-9204 • www.engineeringdesign.com • CERTIFICATE OF AUTHORIZATION: 24642702000

**NJDEP FWW GP #17 & COASTAL GP #13 PLAN**  
 BLOCK 1061, LOTS 42, 51, 53, 54.01 & 54.02  
 CITY OF CAPE MAY  
 CAPE MAY COUNTY, NEW JERSEY

**VINCENT C. ORLANDO**  
 PROFESSIONAL ENGINEER  
 N.J.P.E. LIC. #32498

IF THIS PLAN OR DOCUMENT DOES NOT CONTAIN A RAISED SEAL IMPRESSION BEARING THE NAME AND REGISTRATION NUMBER OF THE ABOVE SIGNED PROFESSIONAL, IT MAY NOT BE AN AUTHORIZED COPY OF THE ORIGINAL DOCUMENT AND MAY HAVE BEEN ALTERED. REPRODUCTION OR FURTHER DISSEMINATION OF THE CONTENTS IN WHOLE OR IN PART REQUIRES PERMISSION IN WRITING FROM ENGINEERING DESIGN ASSOCIATES, P.A.

REVISION	DATE	BY



DATE: 5/24/2023	DRAWN BY: MAJ
SCALE: AS NOTED	CHECKED BY: VCO
PROJECT #: CM-102	SHEET: 1 OF 1