

**PLAN**  
SCALE : 1"=20'

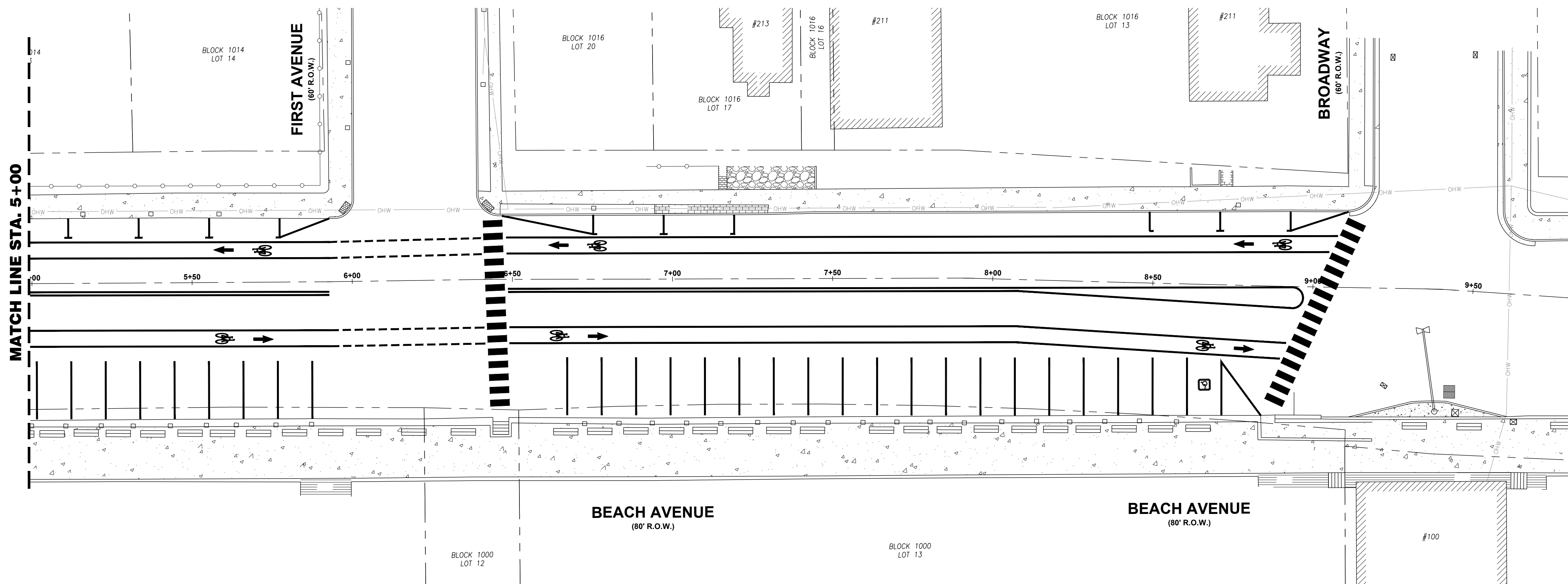

**PLAN**  
SCALE : 1"=20'

**PRELIMINARY 02/26/2024**

**STRIPING PLAN**

**DeBLASIO & ASSOCIATES**  
CONSULTING ENGINEERS AND PLANNERS

4701 NEW JERSEY AVENUE  
WILDWOOD, NJ 08260  
PHONE (609) 854-3311  
FAX (609) 854-4323  
WWW.DEBLASIOASSOC.COM  
Certification of Authorization No. 24CA28284900

**RECONSTRUCTION OF  
BEACH AVENUE  
CITY OF CAPE MAY  
CAPE MAY COUNTY, NEW JERSEY**

Design:	Drawn:	Check:	Date:
CMS	CMS	MAD	2/26/2024

NO.	DATE	APPR.	REVISION

**MARC A. DEBLASIO, PE** DATE  
New Jersey License No. 41599

Scale:	App. No.:	Sheet No.:	Total:
AS NOTED	CEM-11-015	1	1

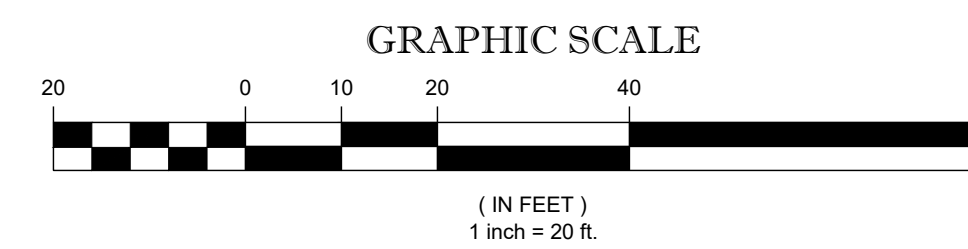

COPYRIGHT 2024, DEBLASIO & ASSOCIATES, P.C. - ALL RIGHTS RESERVED. THE COPYING OR REUSE OF THIS DOCUMENT OR PORTIONS THEREOF, FOR OTHER THAN THE ORIGINAL PROJECT OR THE PURPOSE ORIGINALLY INTENDED, WITHOUT THE WRITTEN PERMISSION OF DEBLASIO & ASSOCIATES, P.C. IS PROHIBITED.